



GT COBRA® BUCKLE SERIES

ITW Nexus™ North America is proud to partner with AustriAlpin and introduce the latest in our line of heavy-duty, high-performance polymer hardware...the GTCobra. Designed with superior crush resistance and tensile loads targeting 500lbf, the GT Cobra™ buckle is a 100% polymer system (no metal). Some of the many advantages: easy to release tabs, won't release under load, & all sizes/models interchangeable means you can use varying webbing sizes. GT Cobra™ is designed for any industrial, commercial, medical, outdoor, or tactical load bearing applications such as Medical Equipment, patient mobility systems, belt systems, pet collars and leashes, shoulder straps, tie down harnesses, backpack systems, medical litters, transportation and seating systems. If you are in need of a product that can reduce your warranty repair concerns, maintain high loads, and provide differentiation in your OEM product, then GT Cobra™ is your ultimate connection solution. Available from ITW Nexus in North America, AustriAlpin™ in Europe, and their authorized distributors.

Available sizes: 1.5", 1.75", 2.0" (38mm, 44mm, 50mm)
Colors: Black, Coyote Brown, Tan, Foliage Green
Styles: Non-Adjust, Single Adjust, Dual Adjust

- Easy to release tabs
- Operating temps -40F to +140F (short-term use -40°F to +270°F)
- Lightweight & cost effective
- Non-conductive and non-corrosive
- Superior crush resistance vs. traditional SR buckles
- Reduced noise and paint chipping
- Does not release under load
- 100% polymer, no metal springs or hinges
- All sizes & models are interchangeable

..... Available Colors



* NOT FOR CLIMBING OR LIFESAVING USE *

1.5" - 38mm GT Cobra

1 1/2" - 38mm Body Loop: 250-0001

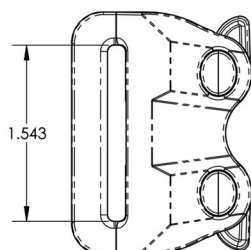
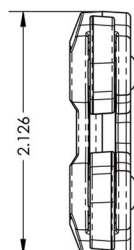

1 1/2" - 38mm Latch Slider: 250-0102

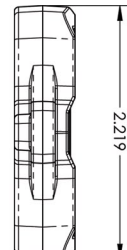
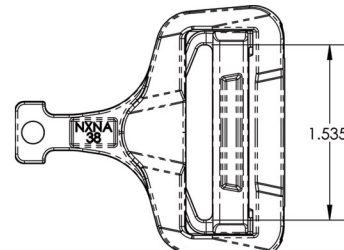

1 1/2" - 38mm Body Slider: 250-0002

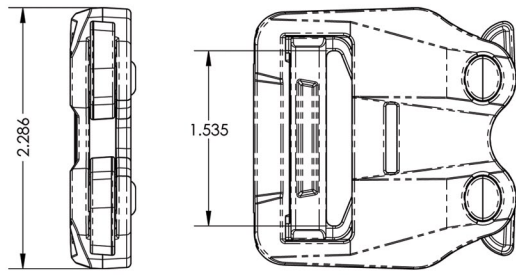

1 3/4" - 38mm Latch Loop: 250-0101

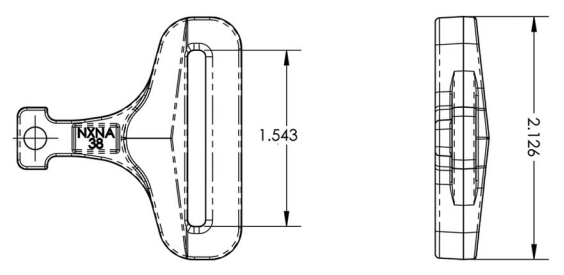

1.75" - 44mm GT Cobra

1 3/4" - 44mm Body Loop: 250-0011

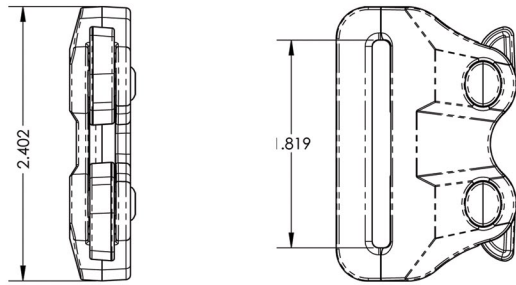

1 3/4" - 44mm Body Slider: 250-0012

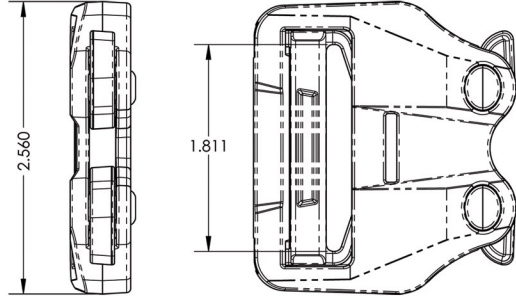

1 3/4" - 44mm Latch Loop: 250-0111

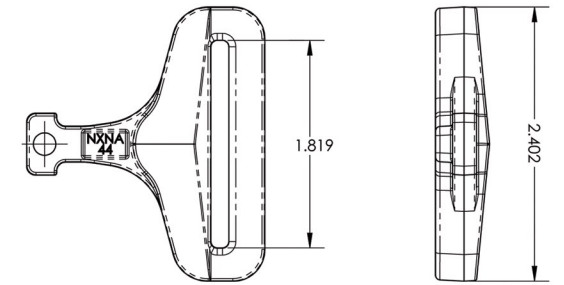

1 3/4" - 44mm Latch Slider: 250-0112

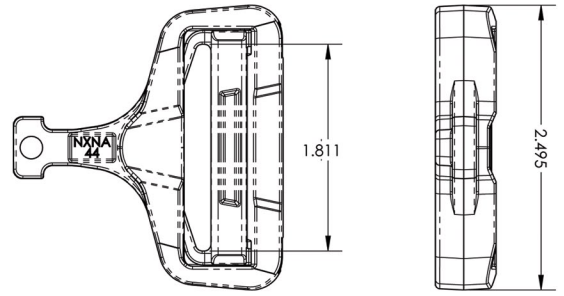

2.0" - 50mm GT Cobra

2" - 50mm Body Loop: 250-0021

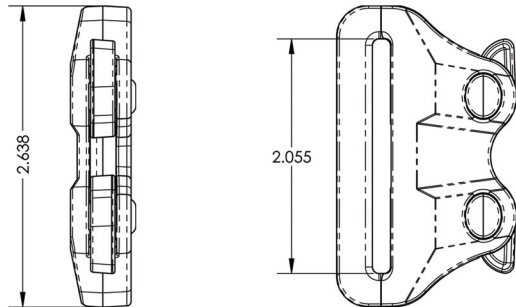

2" - 50mm Body Slider: 250-0022

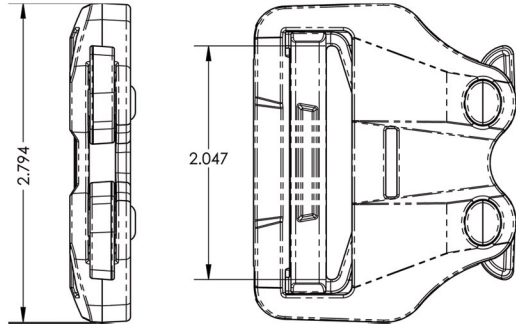

2" - 50mm Latch Loop: 250-0121

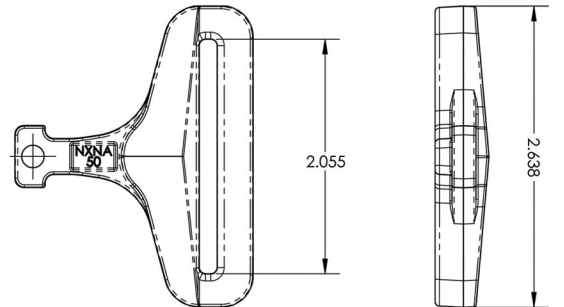

2" - 50mm Latch Slider: 250-0122

